

STEEL

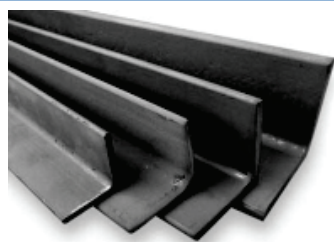

Angle Iron

Sizes:

25x25x3; 30x30x3; 40x40x3; 25x25x5;
30x30x5; 40x40x5; 50x50x3; 50x50x5;
40x40x6; 50x50x6; 60x60x6; 70x70x6; 80x80x6



Channel

Sizes:

76x38; 100x50; 127x64; 152x76

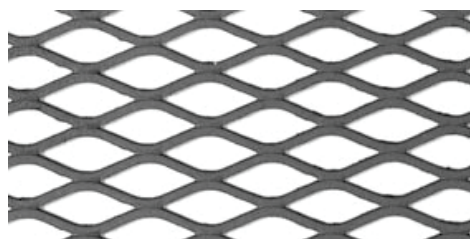

Expanded Metal

Description:

6315F; 6320H



Flat Bar

Sizes:

25x3; 25x5; 30x5; 40x3; 40x5; 40x8
50x5; 50x8; 60x6; 70x6; 50x10; 20x3



Lip Channel

Sizes:

75x50x20x2; 100x50x20x2;
125x50x20x2; 150x50x20x2



Palisades

Description:

Palisade Panel 1.8mx3m; Palisade Spike 1.8m;
Palisade Spike 1.5m; Palisade Spike 2m

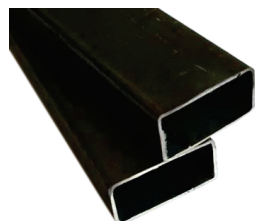

Rectangular Tubing

Sizes:

50x25x1.6; 76x25x1.6x6;
76x38x1.6; 100x50x2

STEEL

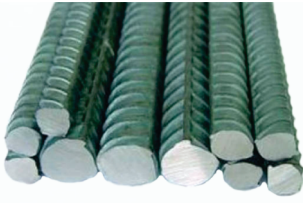

Reinforcing Round Bars

Sizes:
8mm; 10mm;
12mm; 16mm



Round Bar

Sizes:
6mm; 8mm; 10mm;
12mm; 16mm



Round Tubing

Sizes:
15x1.6; 19x1.6; 25x1.6; 32x1.6; 38x1.6; 48x1.6;
50.8x1.6; 76x1.6; 15x2; 19x2; 25x2; 32x2; 38x2; 48x2;
50.8x2; 60x2; 76x2; 101x2; 50x3



Square Bar

Sizes:
10mm;
12mm



Square Tubing

Sizes:
15x15x1.6; 19x19x1.6; 25x25x1.6; 32x32x1.6; 38x38x1.6;
50x50x1.6; 50x50x3; 76x76x1.6; 76x76x1.6x7.2m;
101x101x2; 19x19x2; 25x25x2; 32x32x2; 38x38x2;
50x50x2; 76x76x2



Sheets

Description:
1.6mm HR; 2mm HR; 3mm HR; 4mm HR; 5mm HR;
Cold Rolled 1mm; 6mm HR; 10mm HR; 0.6mm GALV;
0.8mm GALV; IBR 0.5mm; Corrug 0.5mm; 2.5mm HR

We also supply Equal Angles, Unequal Angles, Joists, IPE Sections, Universal Columns, Universal Beams, Hexagon Bar, Open Channels, Hand Railings, Hand Rail Stanchions & Bends, Reinforcing Mesh, Palings, Cross Members, IBR Sheeting, Corrugated Sheeting, Flashings, Bullnosing, Chromadek Sheeting in variety of colours, Polycarbonate Sheeting in variety of colours